

ALL DIMENSIONS TO BE CHECKED ON SITE
NO DIMENSIONS TO BE SCALED FROM THIS DRAWING
DRAWING IS TO BE READ IN CONJUNCTION WITH RELEVANT CONSULTANTS DRAWINGS

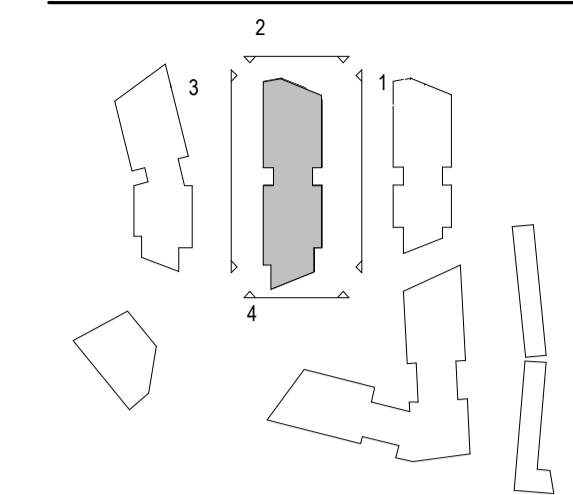

1 BUILDING B - ELEVATION - EAST
1 : 200



2 BUILDING B - ELEVATION - NORTH
1 : 200



4 BUILDING B - ELEVATION - WEST
1 : 200



3 BUILDING B - ELEVATION - SOUTH
1 : 200

MATERIAL LEGEND

1. Selected Buff Coloured Brick Outer Leaf
2. Selected Buff Coloured Brick Outer Leaf to Textured Coursing
3. Selected Dark Coloured Outer Leaf
4. Selected Dark Coloured Brick Outer Leaf to Textured Coursing
5. Vertically Ribbed Aluminium Cladding in Selected Powder Coated Colour
6. Aluminium Cladding in Selected Powder Coated Colour
7. Aluminium Framed Door and Window System with Integrated Ventilation Grille in Selected Powder Coated Colour
8. Aluminium Framed Window System in Selected Powder Coated Colour
9. Pre-Fabricated Balcony with Selected Aluminium Powder Coated Facia and Balustrade
10. Aluminium Framed Winter Garden Glazing System in Selected Powder Coated Colour
11. Plaster Render Finish in Selected Colour
12. Aluminium Capping in Selected Powder Coated Colour
13. Recessed Cladding in Selected Bronze Coloured Aluminium
14. Cladding Panels in Selected Bronze Coloured Aluminium
15. Retractable Awning within Recessed Bronze Coloured Cladding
16. Aluminium clad canopy in selected powder coated colour
17. Aluminium framed ventilation louvre in selected powder coated colour
18. Obscured Glass Privacy Screen
19. Obscured Glazing

REV	DATE	DESCRIPTION	CKH	DRN
P2	DEC. 2021	ISSUED FOR PLANNING		HJL
P1	FEB 2021	ISSUED FOR PRE PLANNING	SA & BG	AS

ISSUED FOR PLANNING APPROVAL

CLIENT
Cornel Living

PROJECT
Cornelscourt Residential Development, Dublin 18

DRAWING
GA ELEVATIONS - BUILDING B

PROJECT NUMBER	DATE	
950558	10/2020	
SCALE@ A1:	DRAWN/CHECKED:	
As indicated	MCCOY/SABG	
STATUS CODE:	DRAWING NUMBER	REVISION
A1	COR-HJL-BB-ZZ-DR-A-2005	P2

Henry J Lyons
Architecture + Interiors
henrylyons.com +353 1 888 3333
info@henrylyons.com 51-54 Pearse Street
Dublin D02 KA66